



# FOLD-FLAT BUILDING EXPANSION SET # 1

Before proceeding with this document, make sure you have read the beginners guide to card modeling included with this model set! All pages have user selectable options for the graphics which you can adjust prior to printing. Please see the section on 'DRAGON LAYERS' in the Beginners Guide for more info.

F A T   D R A G O N   G A M E S

[www.fatdragongames.com](http://www.fatdragongames.com)



## BUILDING WALLS

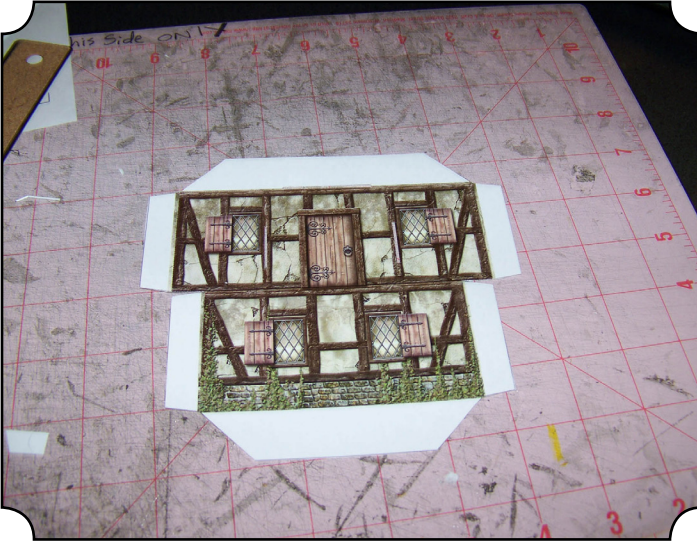

1: Cut and test fold the wall pieces as shown.

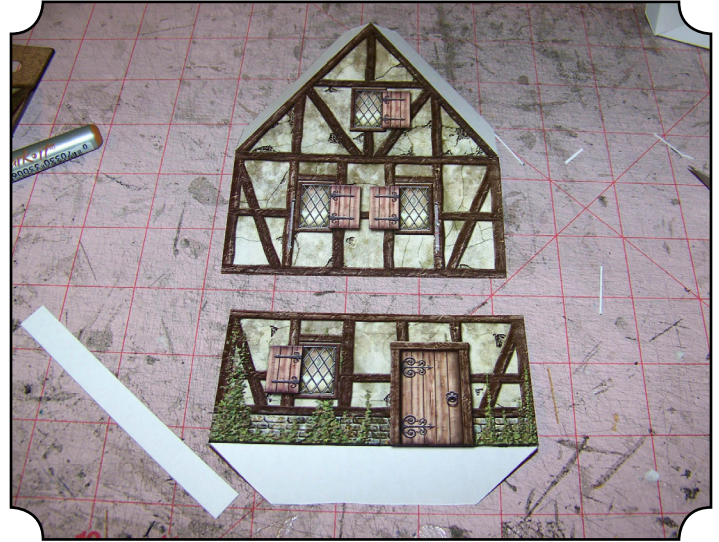

2: Edge all pieces at this time with a brown or gray marker.

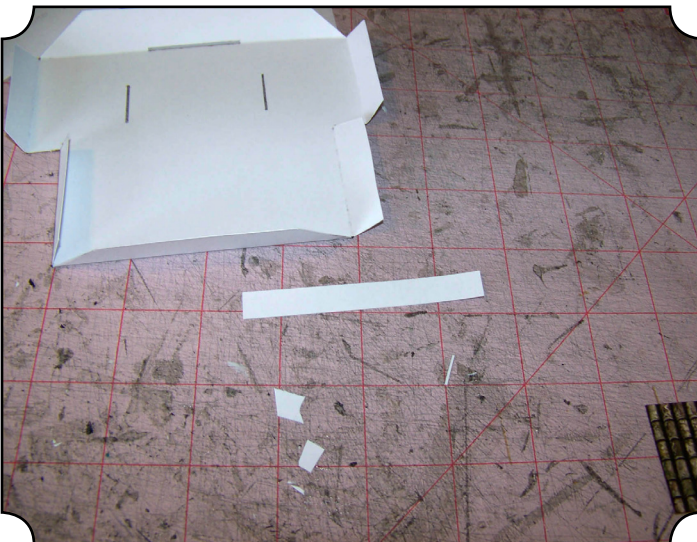

3: While not necessary, we suggest (especially if you are using metal miniatures) that you cut a scrap strip of cardstock out slightly wider than the two slots on the building walls.

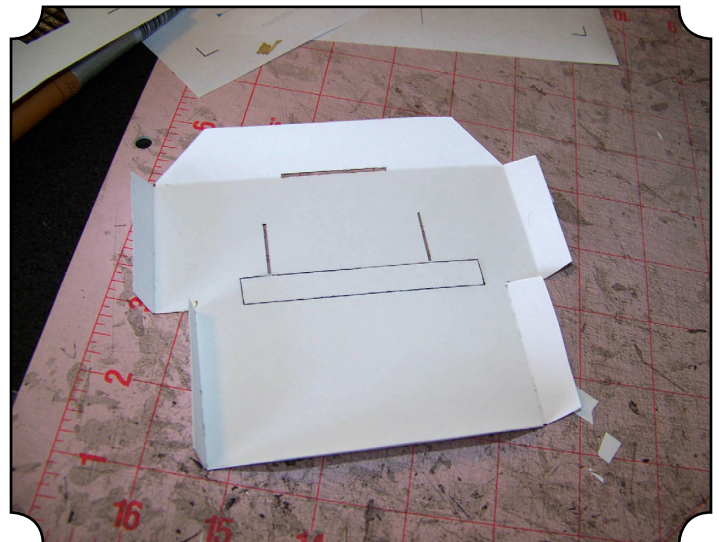

4: Glue this scrap under the slots as shown to reinforce them.



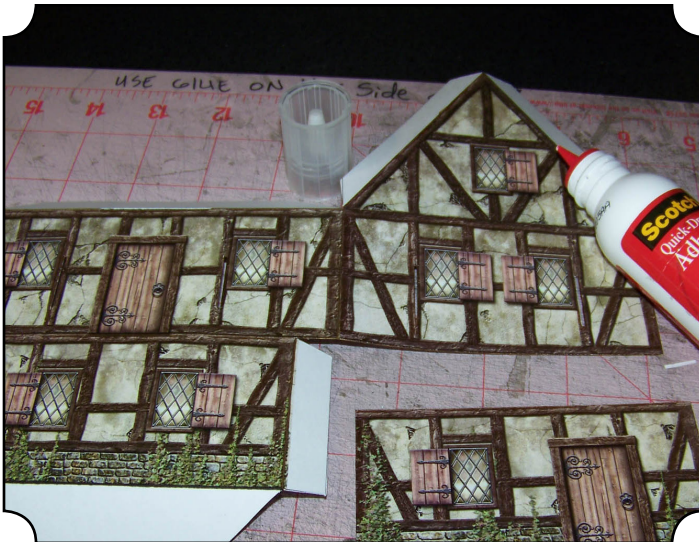

5: Glue the wall sections together as shown above.

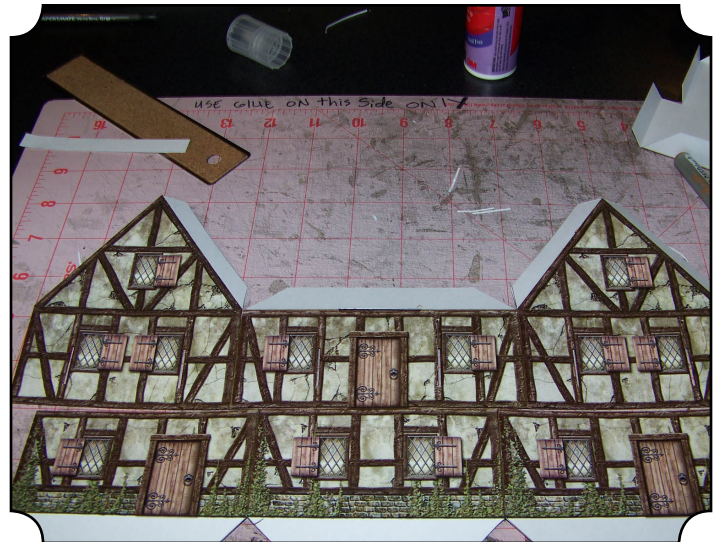

6: Continue until you have all four walls joined together into one long strip.



7: Fold the outer end walls inward, so that the unglued ends meet in the middle as shown above. Proceed to then glue the tab(s) to finish the main wall model.

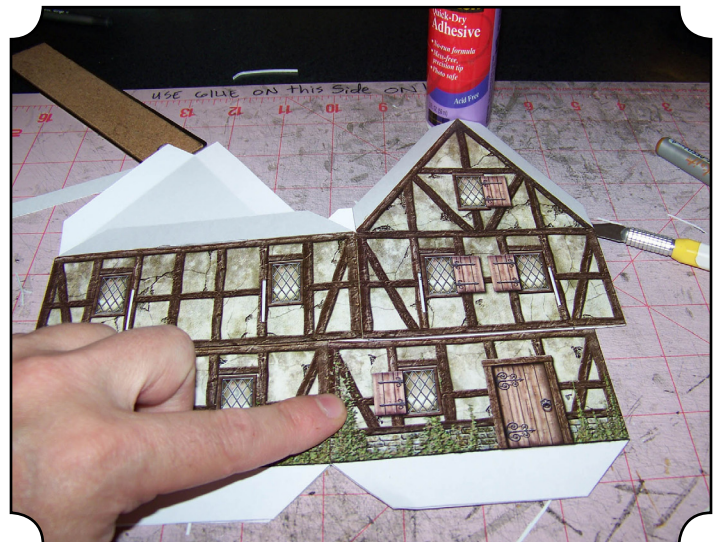

8: Finish gluing and set aside to fully dry before proceeding.



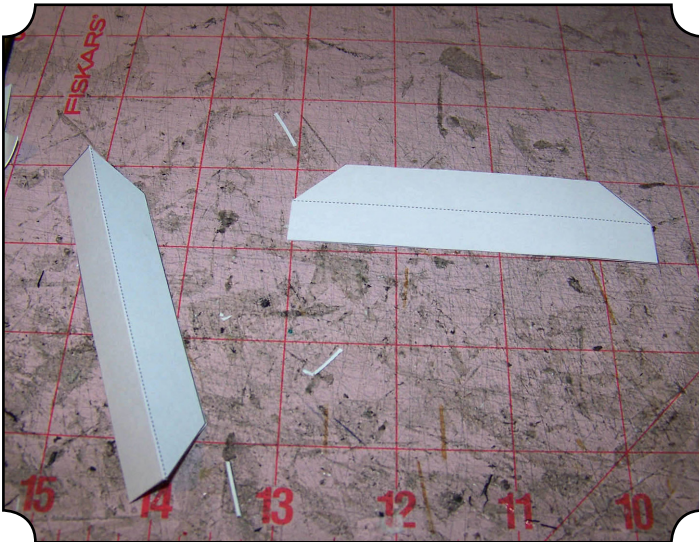

9: Cut out the two internal braces. These are not absolutely necessary for final construction, but they will make the finished model look much better and prevent the cardstock walls from bowing.

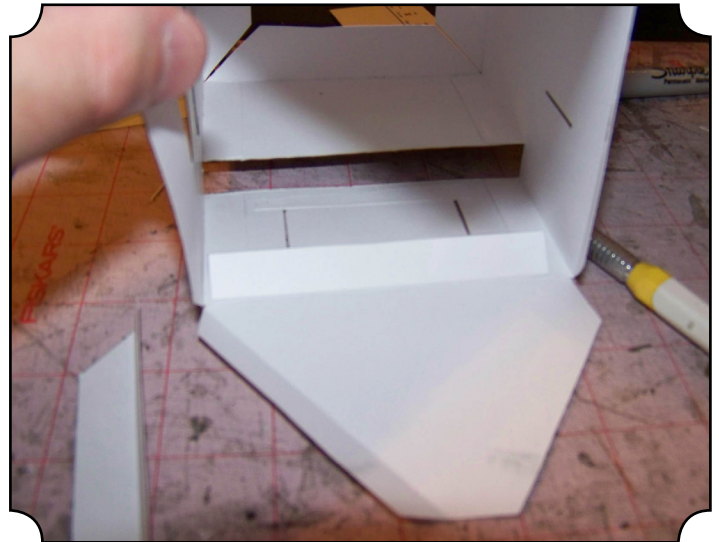

10: Glue the braces, one per end wall (the walls with the pointed peaks) along the top edge of where the tops of the side walls end (just where the angled edges begin.)



11: Another view showing the position of the interior brace.

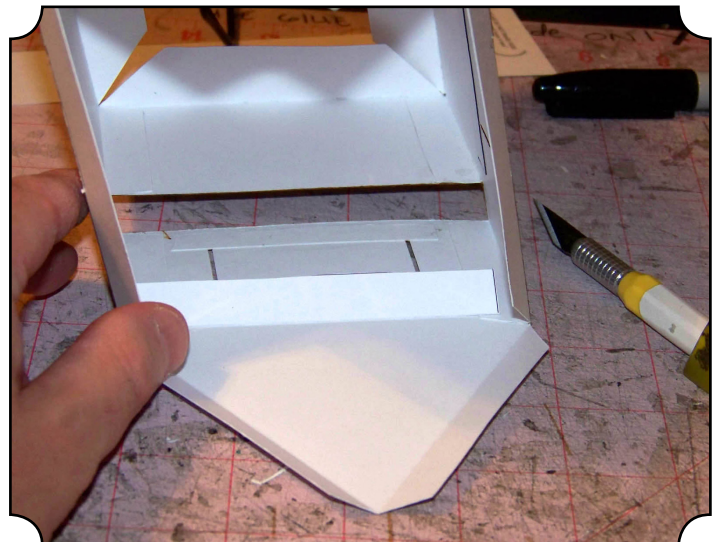

12: The brace is folded flat for storage, and then folded back to a 90 degree angle for support of the building.



## ROOF AND ATTACHMENTS



1: Cut and score the roof piece as shown.

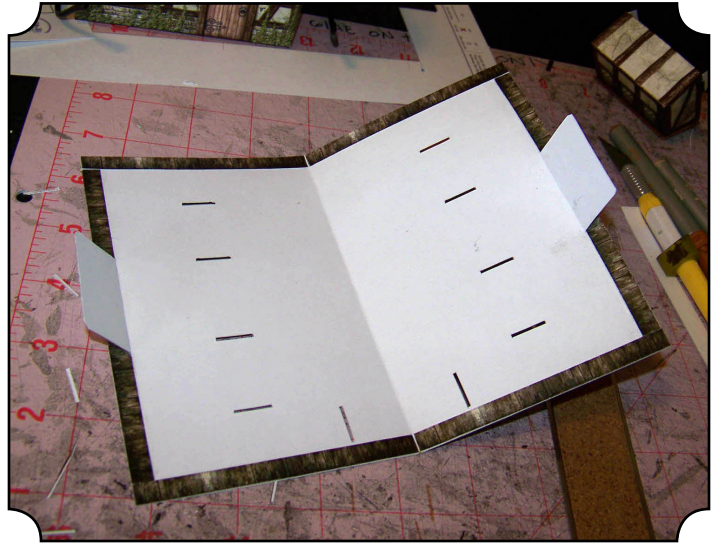

2: Fold the edge flaps inward and glue, being careful not to accidentally glue the two tabs.

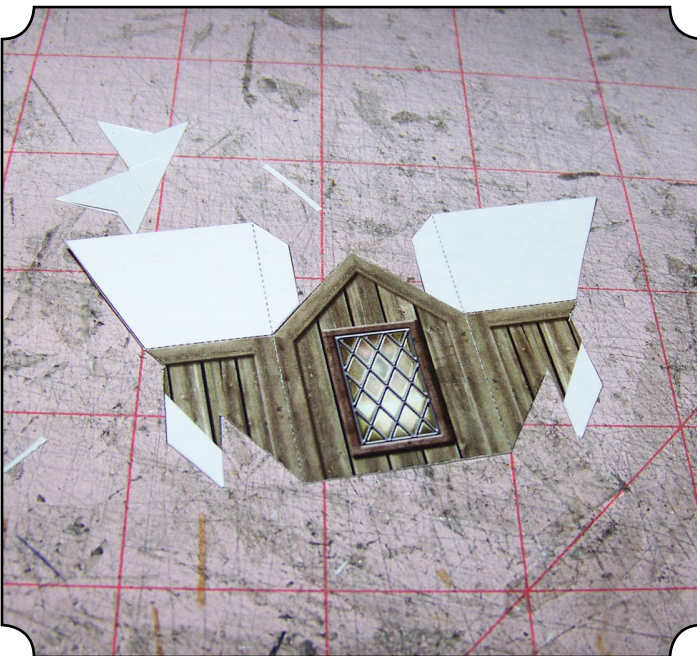

3: Cut, score and test fold the dormers.

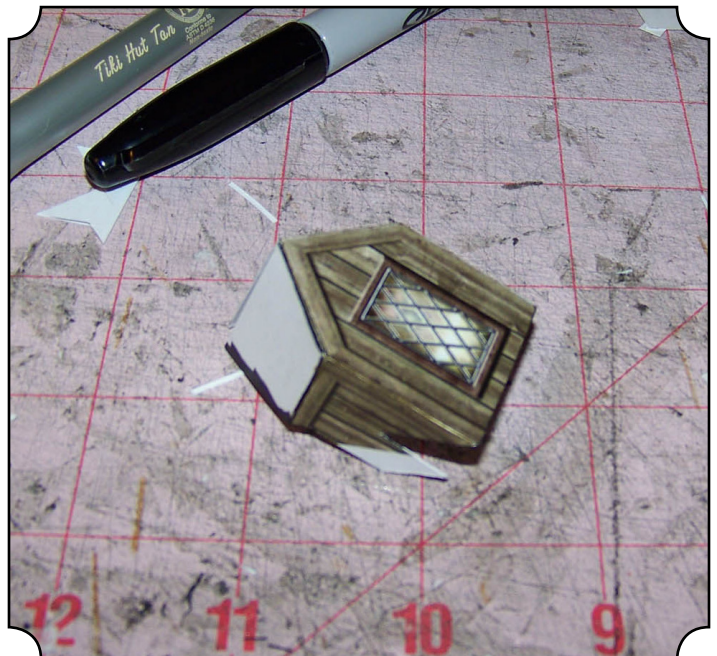

4: Glue the top flaps as depicted above.



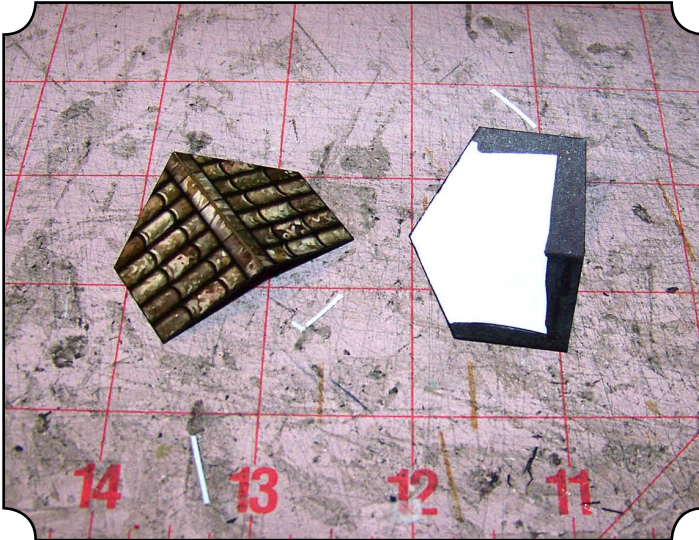

5: Cut and score the top piece, and edge the lower side with a black or brown marker.

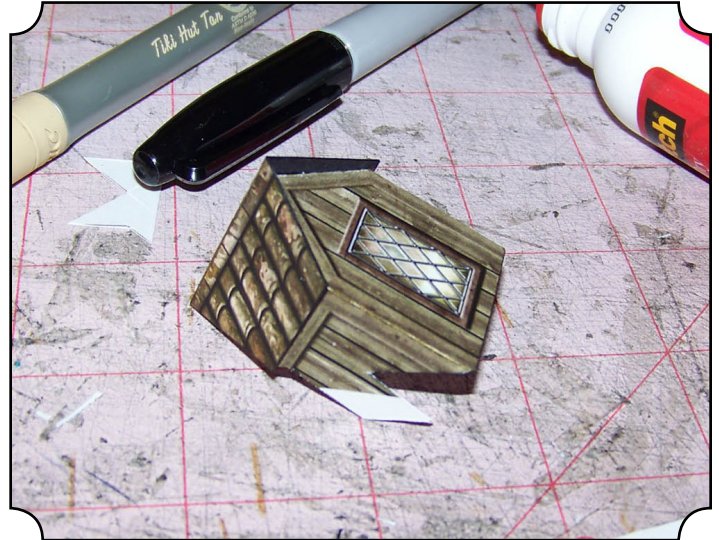

6: Glue to the main dormer piece, making sure the rear edge of flush with the dormer, and the top piece extends over the sides and FRONT of the dormer piece.

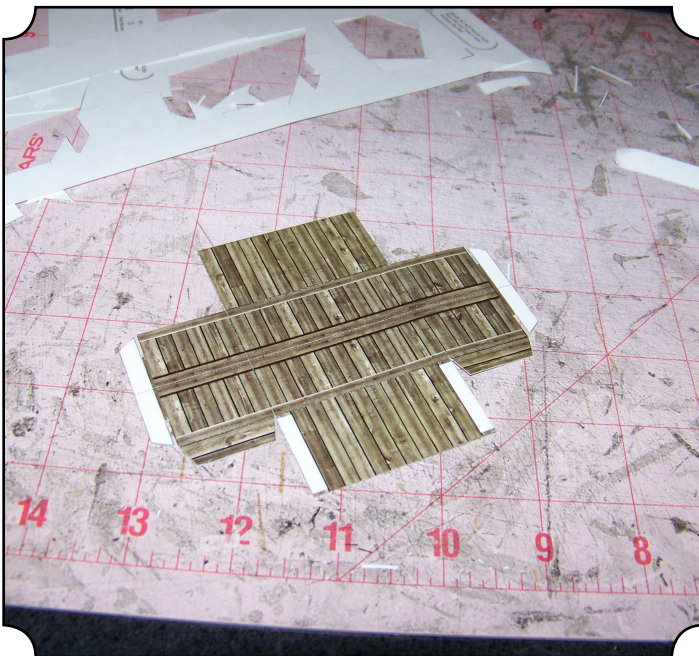

7: Cut and test fold the balcony model.

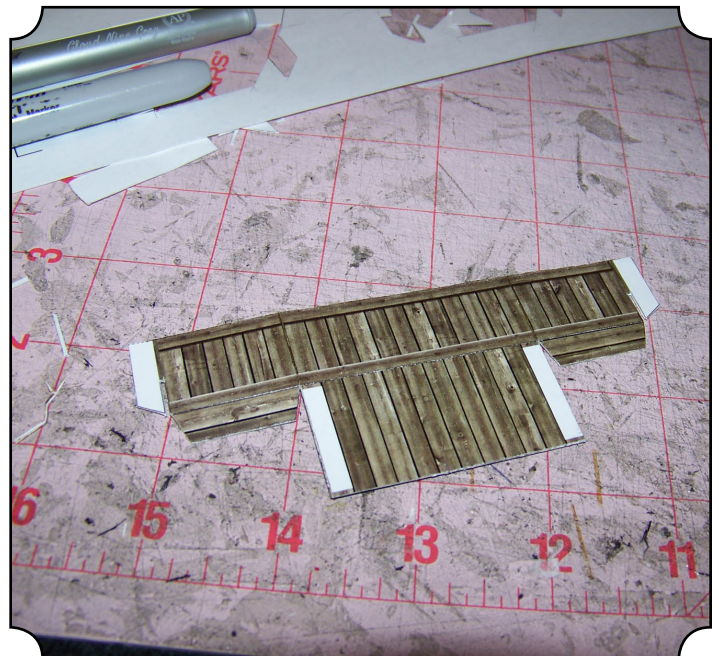

8: Glue in half and allow to dry.



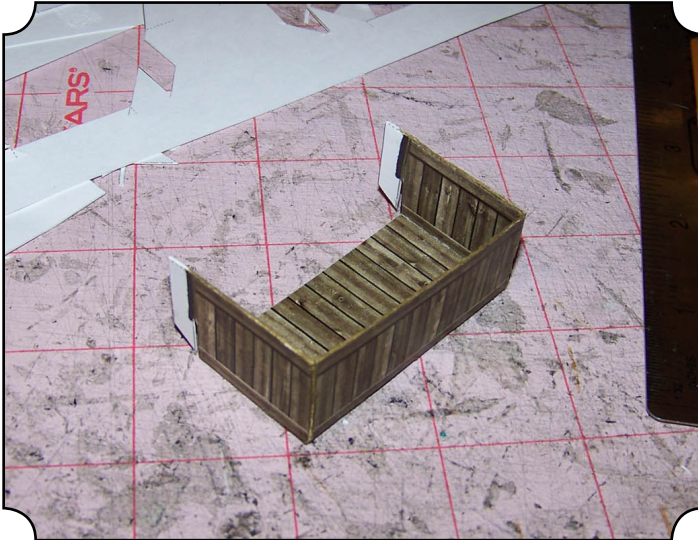

9: Glue the lower tabs and set aside to fully drive.



10: The roof adaptors can be used to position miniatures on the rooftops.



11: For the chimneys, you will need to cut a little area away on the inner wall tabs where the slots for the chimney are. Since the exact position can shift slightly depending on various factors during construction, we have not marked a specific area on the tab. Simply put the roof on and draw a small pencil mark through the slot onto the tab.



12: Cut away a small area on the tab where your pencil mark is to allow the chimney tabs to go through it.



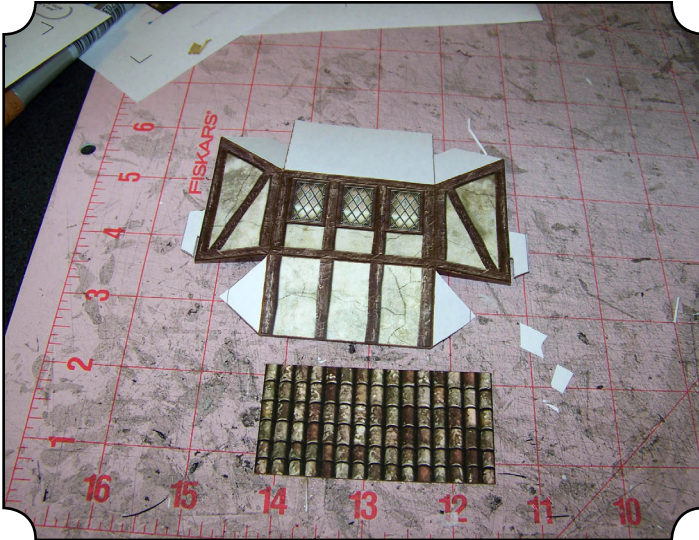

13: Cut and score the window box pieces as shown.

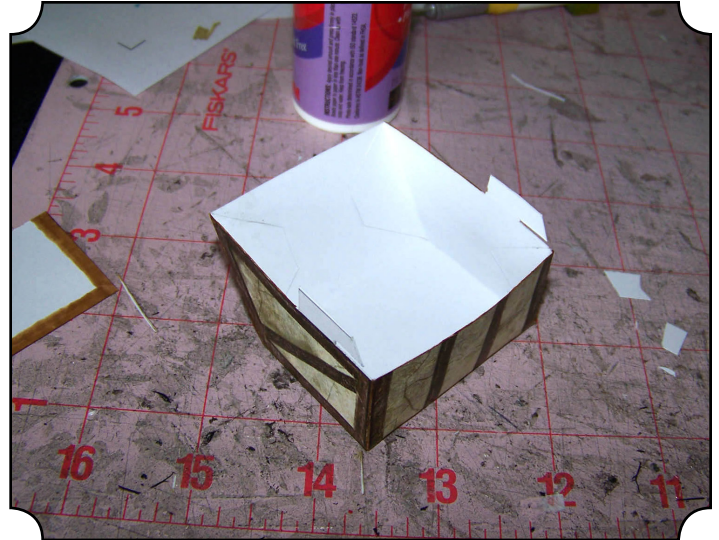

14: Glue the tabs as depicted and allow to dry.

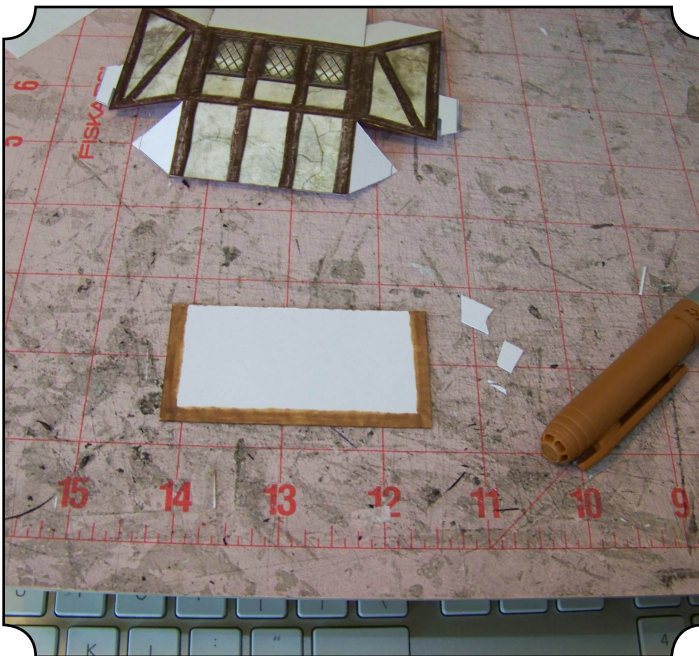

15: Color the underside of the roof piece with a brown or black marker.

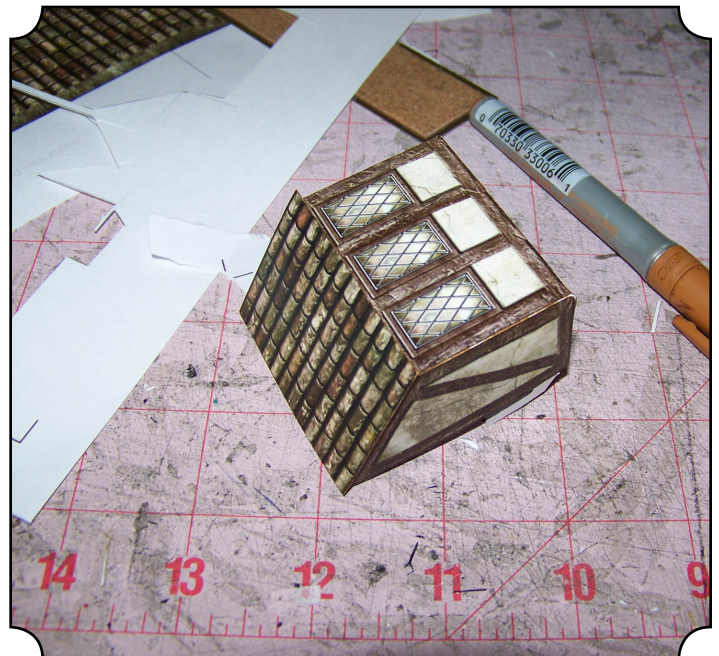

16: Glue to the window box, allowing the sides and forward edge to extend beyond the window box walls, but remain flush with the rear edge.





## ASSEMBLING YOUR FOLD-FLAT BUILDING

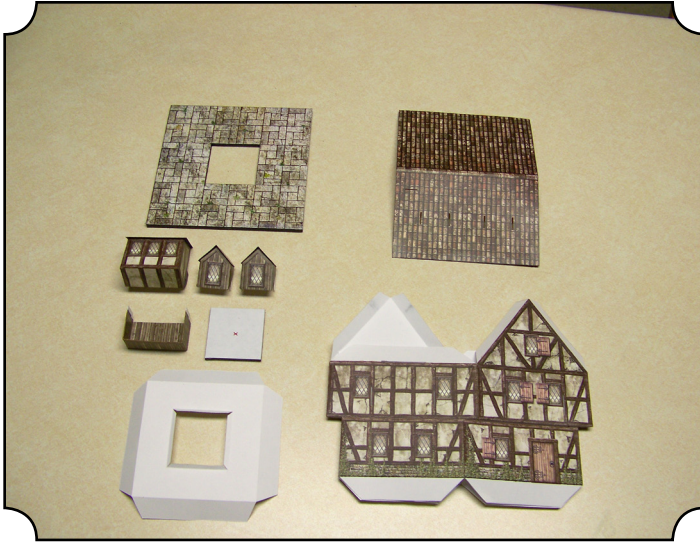

1: Collect the individual pieces you want to use.

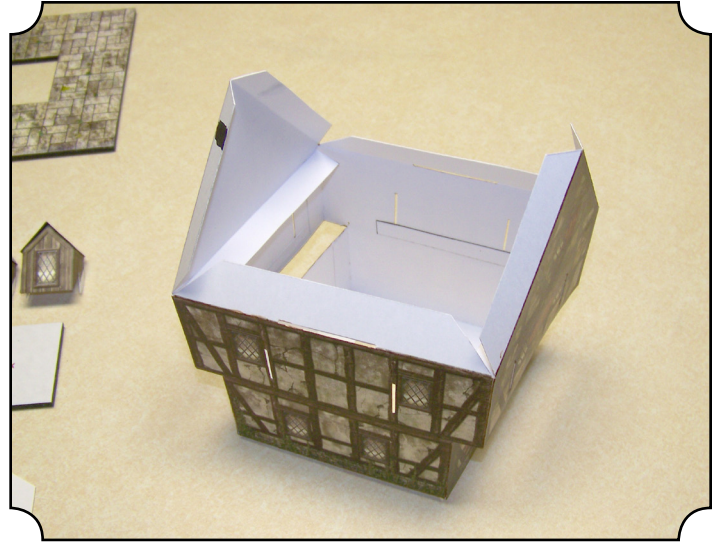

2: Fold out your wall model into a box-shape.

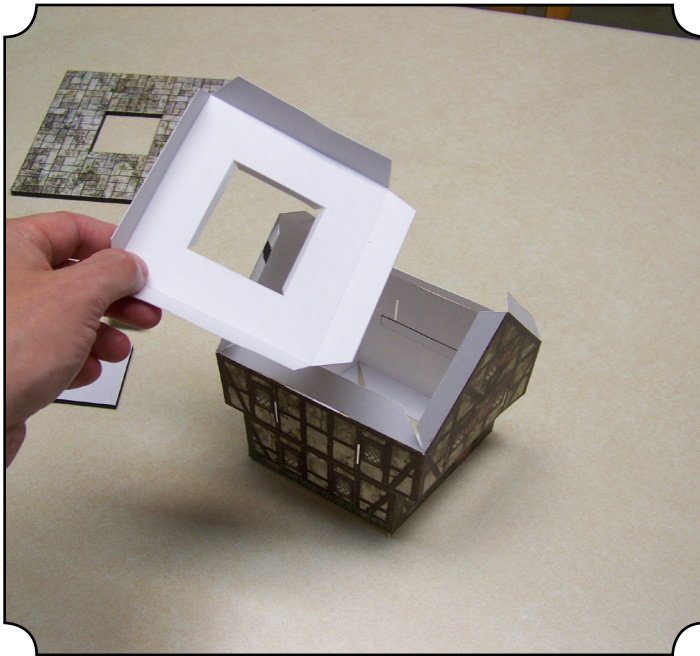

3: Insert the base adaptor through the roof as shown.

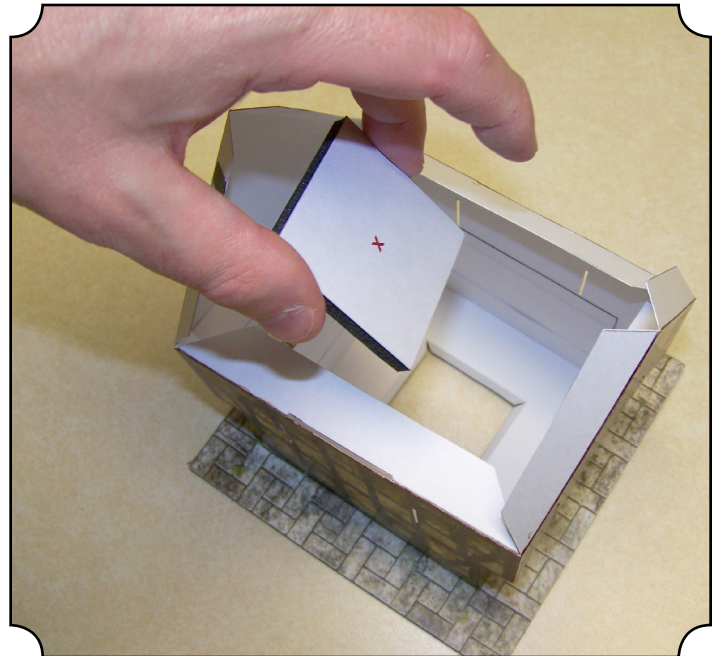

4: When you make your base tile, glue the tile piece to a section of foamcore. Once the tile is dry on the foamcore, cut out the center 2" square and keep. This will be used to lock your model into the base tile.



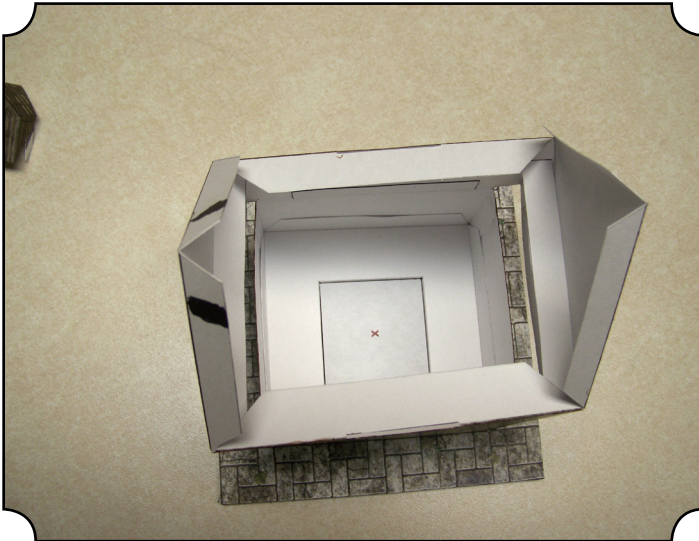

5: By using the 2" square of foamcore to lock the base adaptor tabs into the ground tile, you effectively prevent any shifting of the building off of the base during game play except in extreme cases.

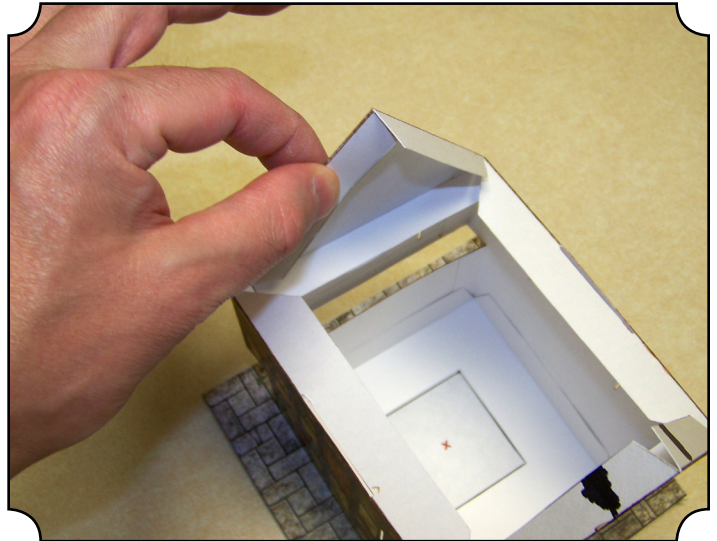

6: Before attaching your roof, fold the edge tabs on the wall peak downward so they do not interfere with the roof. These tabs have no role in supporting the roof, but simply to keep the wall peaks from bowing.

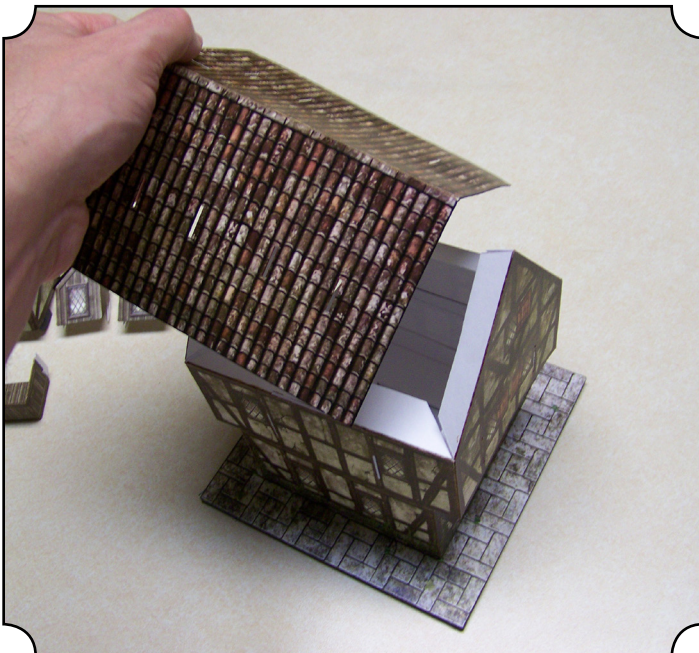

7: Attach the roof, and then proceed to attach balconies, dormers, window boxes, etc. using the slots on the building.

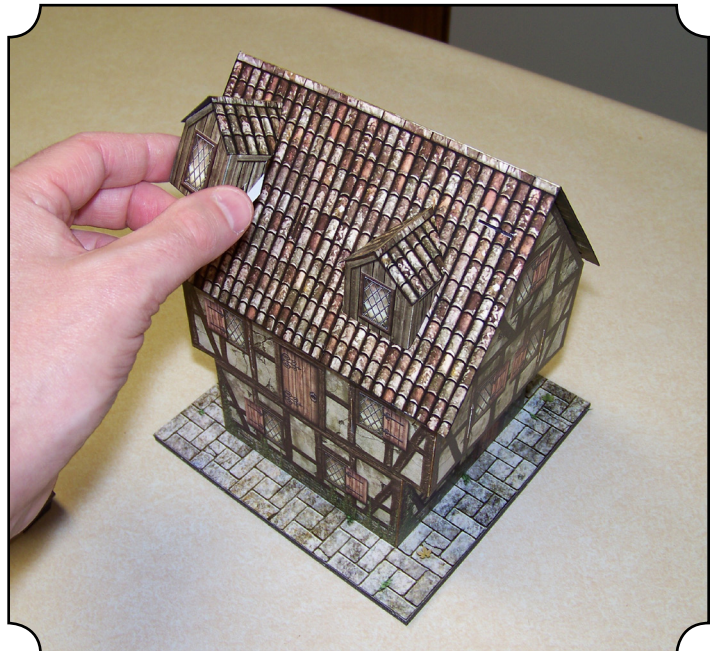

8: The finished model is designed to withstand repeated take-downs without problem, and the balcony is designed to support metal miniatures.





## ALTERNATE BASING USING E-Z LOCK 1" HOLES.

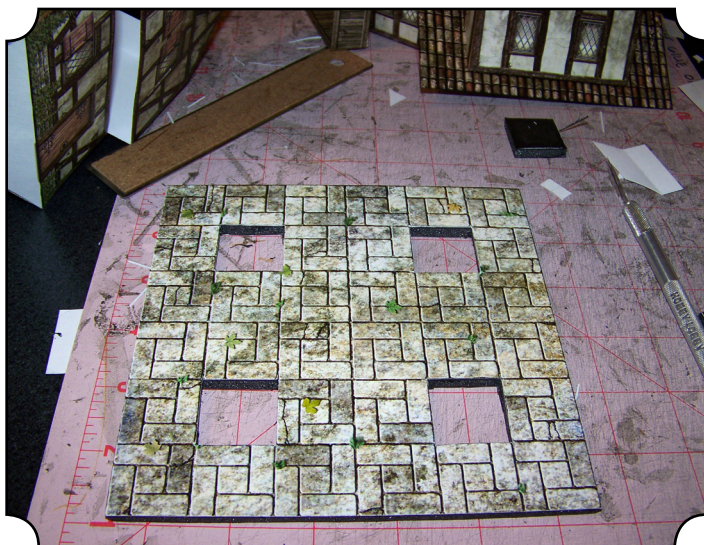

1: Cut out the standard E-Z Lock hole arrangement.

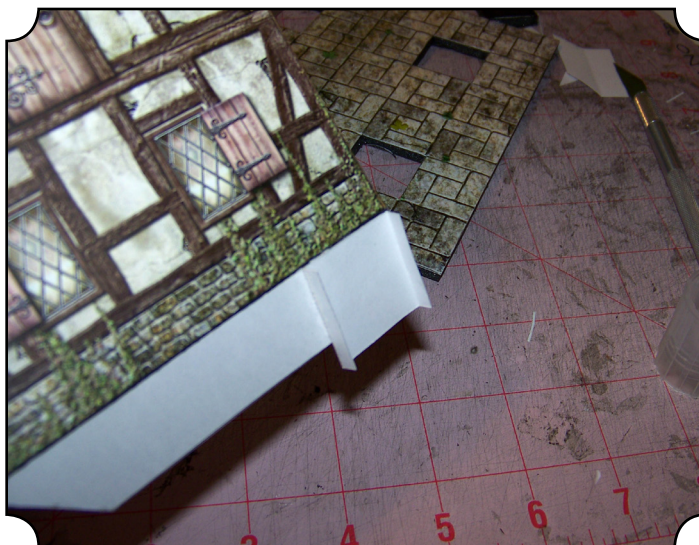

2: Glue the small E-Z Lock adaptors to the corners of the building bottom flaps, two on opposite corners are required, but four will make your building even more stable.

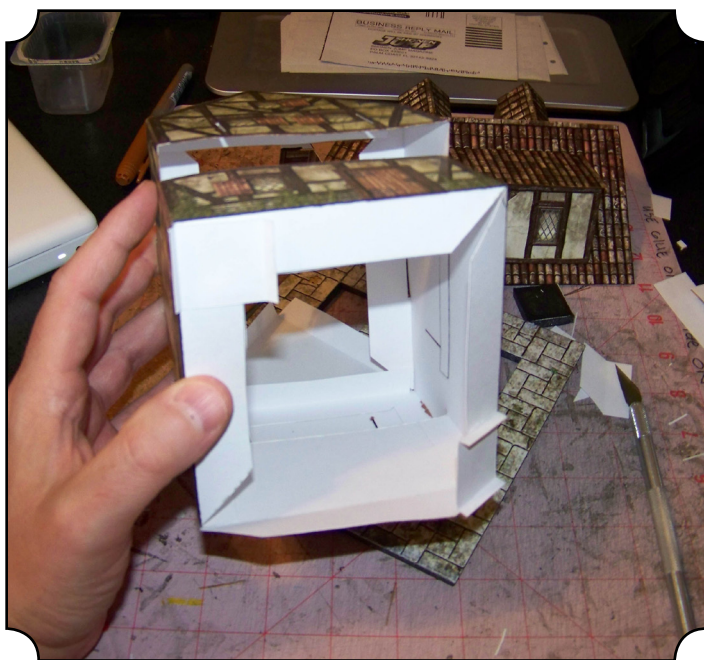

3: Make sure the adaptors are glued to only one tab or your building will not fold flat.