



WINTERHAWK RUINS



Before proceeding with this document, make sure you have read the beginners guide to card modeling included with this model set.

Miniatures are from Reaper Miniatures/Asylum Miniatures: www.reapermini.com



FAT DRAGON GAMES



Walls

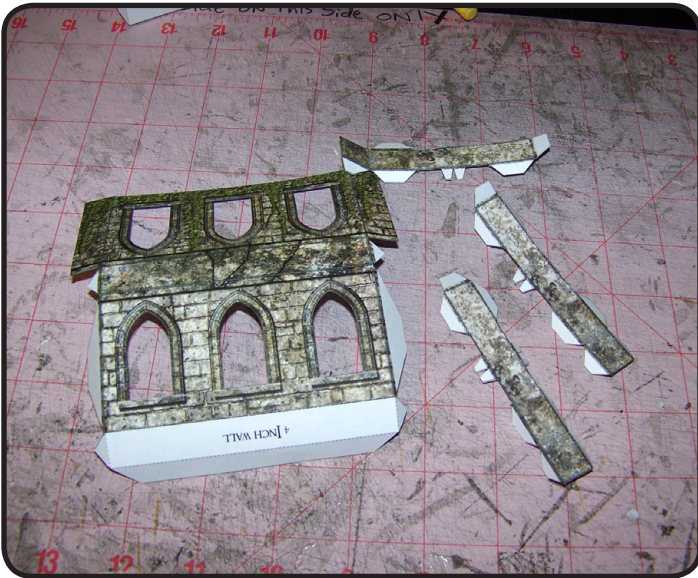

1: Cut and score the wall sections and edge as desired.

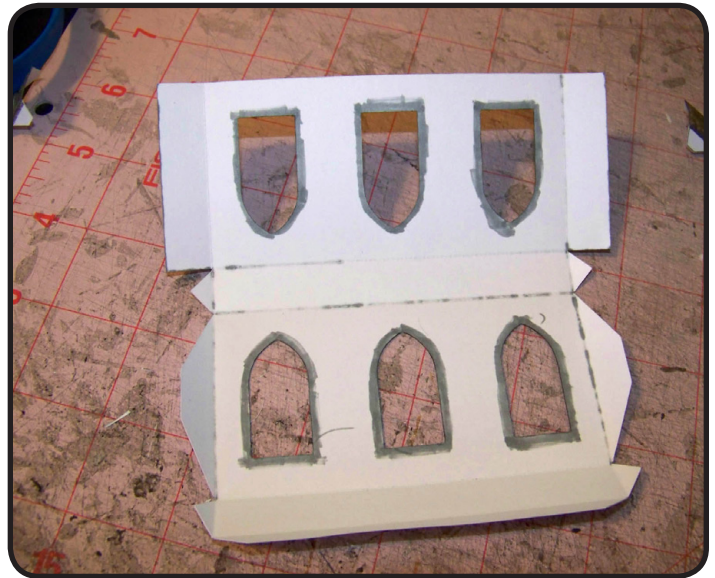

2: Color the inside opening edges with a gray marker in case there is any misalignment on the window interiors once glued.



3: Glue the window interior shown.

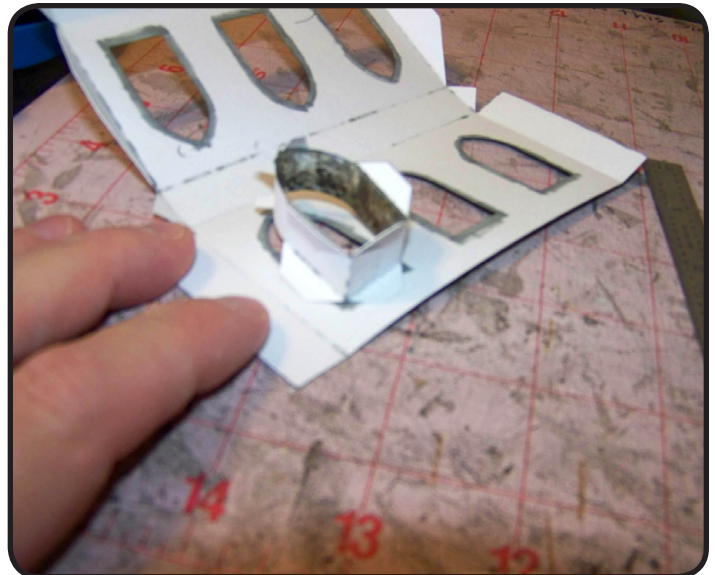

4: Glue the BOTTOM tab first and allow to dry, making sure the window interior is centered with the wall opening. Make sure your window interior is not too low, but rather right at the edge of the opening in the wall. If you glue it too low the peak will not align properly.

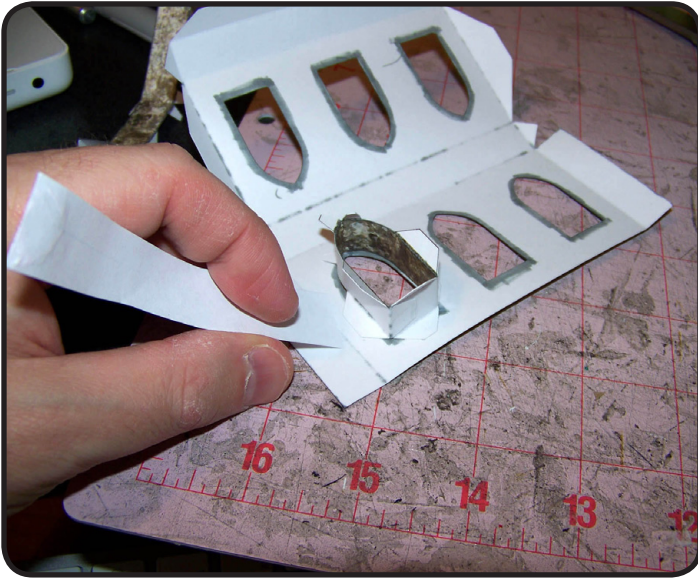

5: It will be easiest to apply glue to the side tabs with a scrap of paper as shown above, **ONLY GLUE THE SIDE TABS** at this step! Use your fingers on either side of the frame piece to keep the sides from bowing outward and keeping them aligned with the edge of the opening.

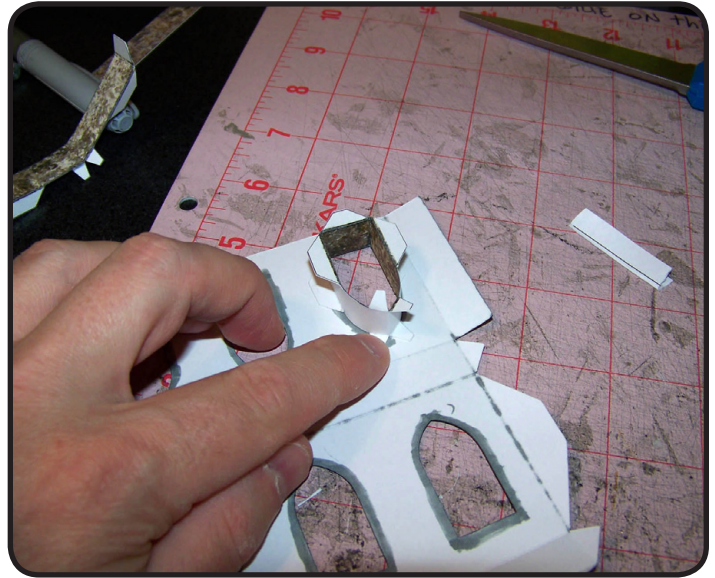

6: Finally glue the top peak tabs, holding down with your fingers as they dry.



7: Apply glue to **ONLY** the window opening tabs, and then shut the wall assembly over them, carefully aligning each opening with the window side walls. This is a **VERY** crucial step.

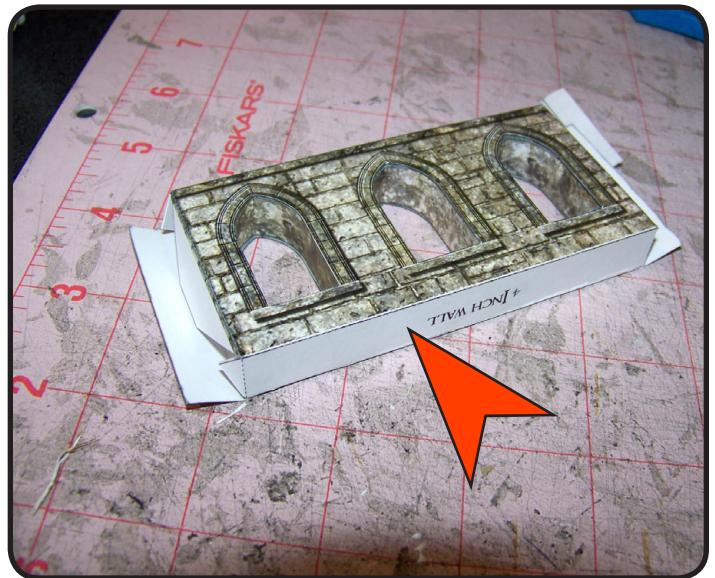

8: Once the window tabs have dried, then glue the long bottom tab as shown above.



9. Finish by gluing the side tabs and set aside to dry.

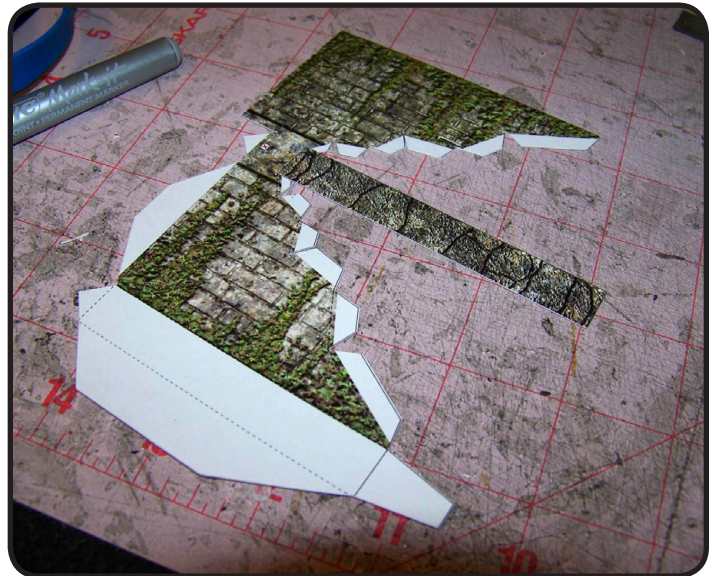

10: The short ruined wall glues much like a basic wall, cut, score and test fold to begin.

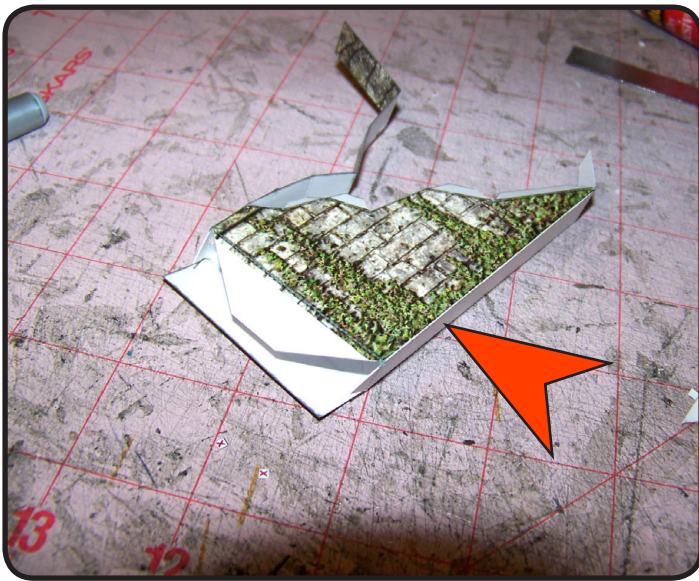

11: Glue the bottom flap and allow to dry.

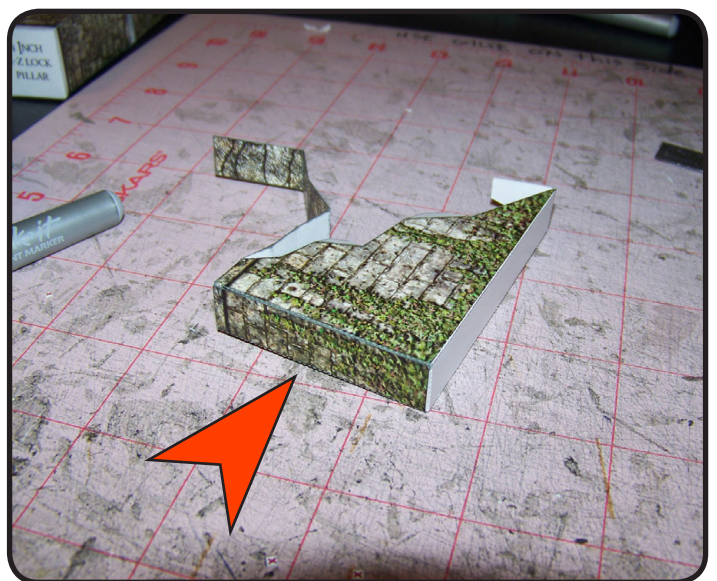

12: Glue the side flap.

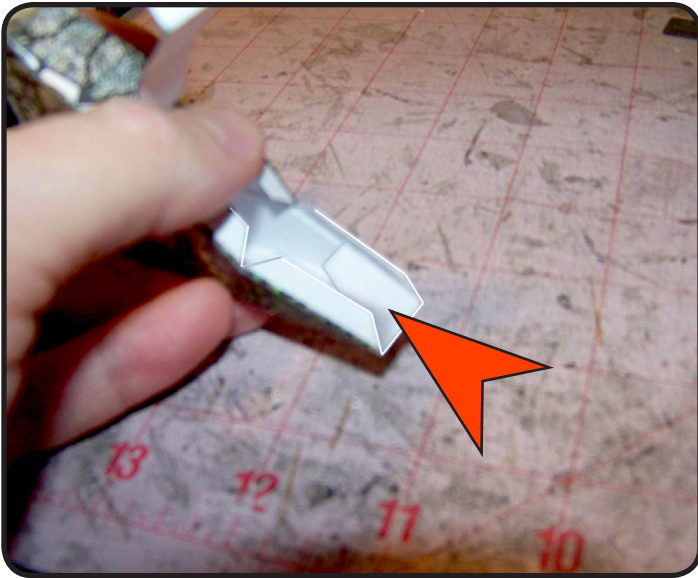

13: Make sure the tab at the very bottom is folded UNDER the two tabs on either side of it as shown above.

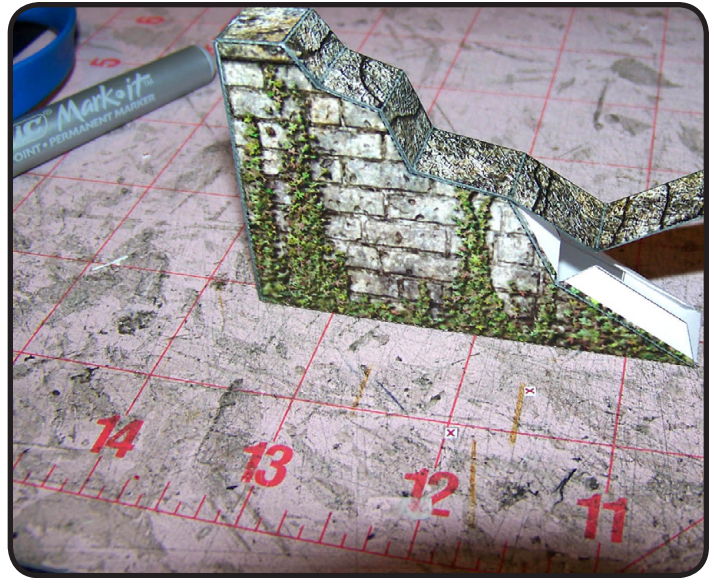

14. Start gluing the edge strip at the top as shown, working with one group of tabs at a time (maybe two groups for experienced modelers, but never more than that.) Keep moving down the strip until all tabs are glued.

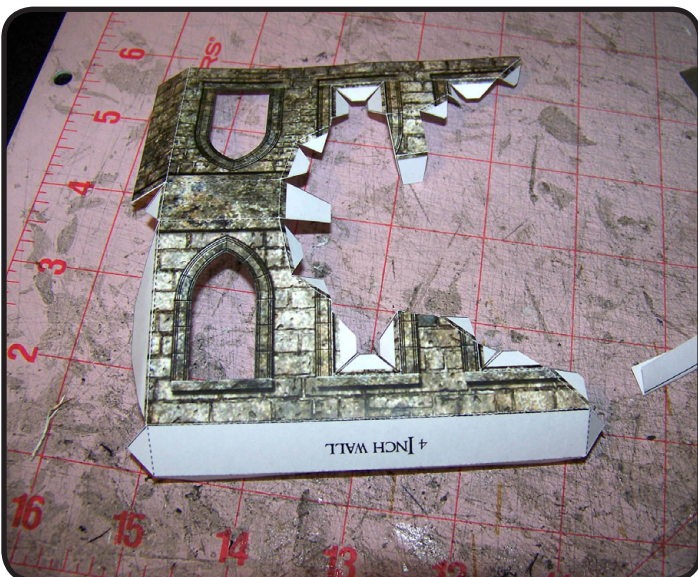

15: For the long ruined wall, cut, score, blah blah blah...



16: Edge the interior, yadda yadda yadda...



17: Remember to begin gluing the interior window frame with the bottom tab only.

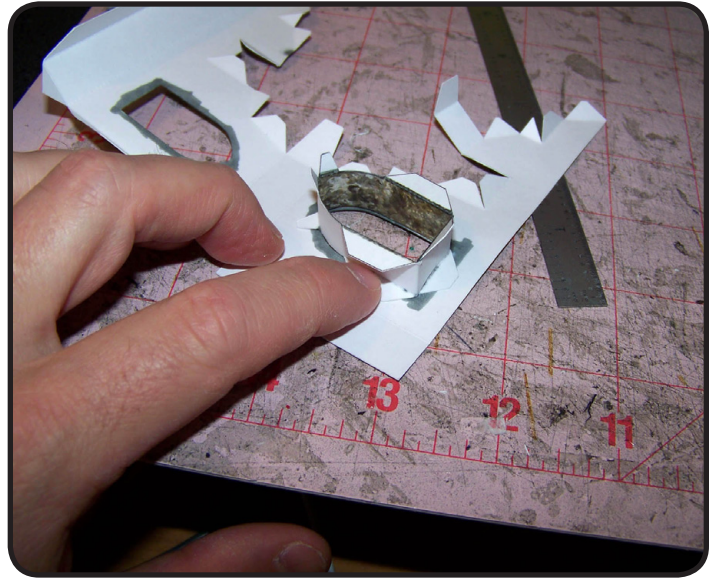

18: Glue the side tabs, holding in place until dry to make sure they do not flex outward.

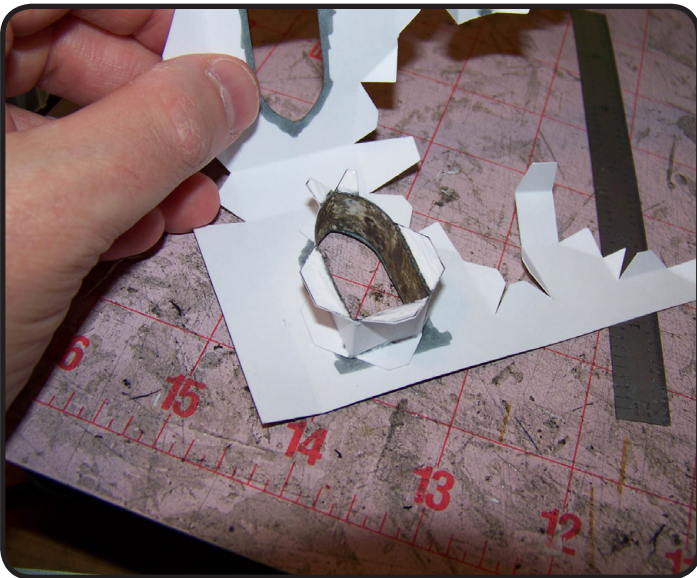

19: Once the frame has been glued to one wall side, apply glue to the opposite side's tabs and fold the wall into place.

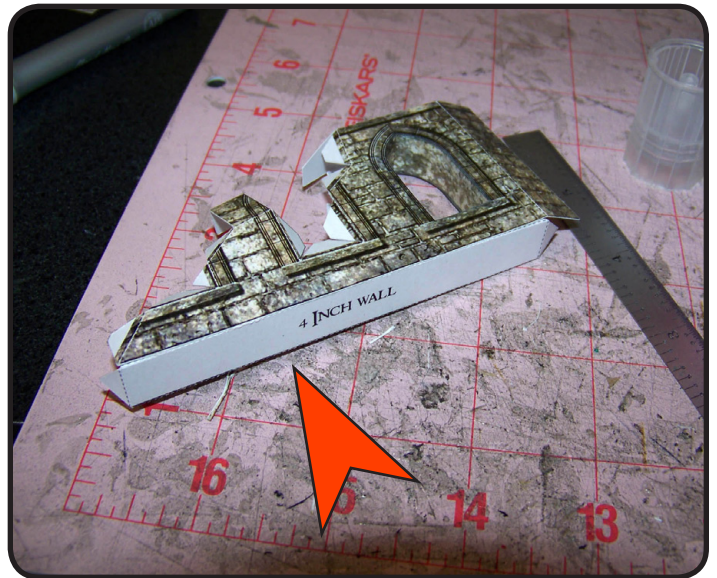

20: Next glue the bottom flap as depicted above.

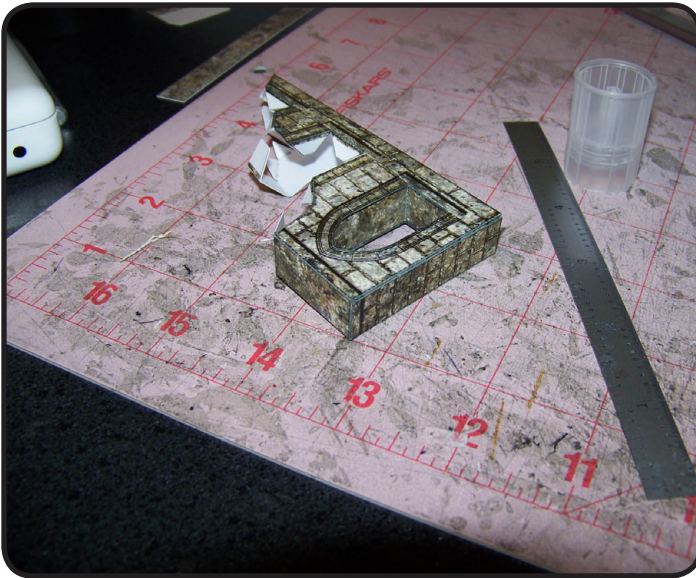

21: Glue the side flap as shown.

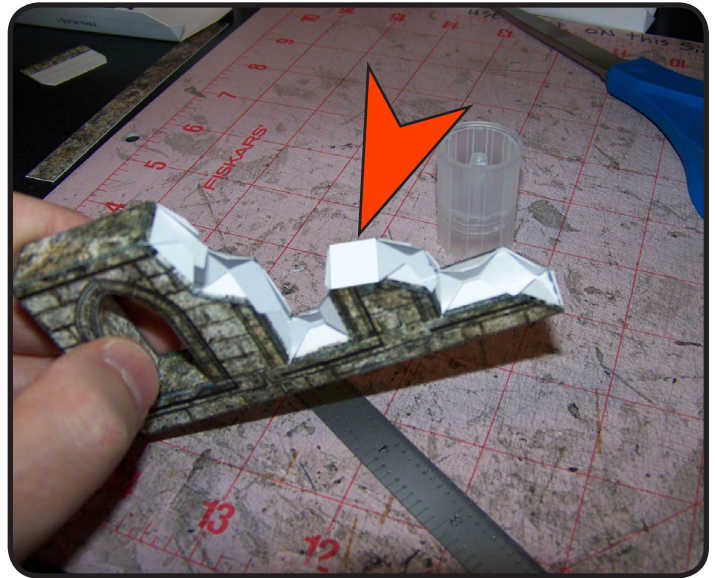

22: Glue the cross brace flap into place.

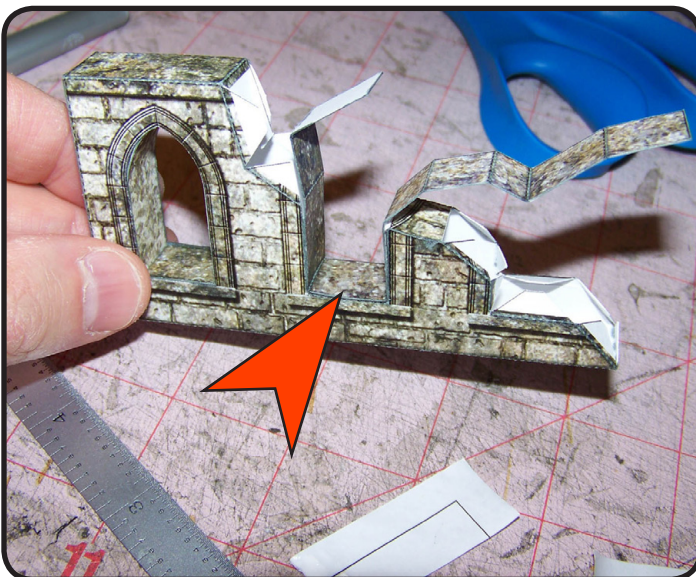

23: When gluing the edge strip into place, begin in the MIDDLE, gluing the window interior first (start with the bottom only, then glue the sides.)

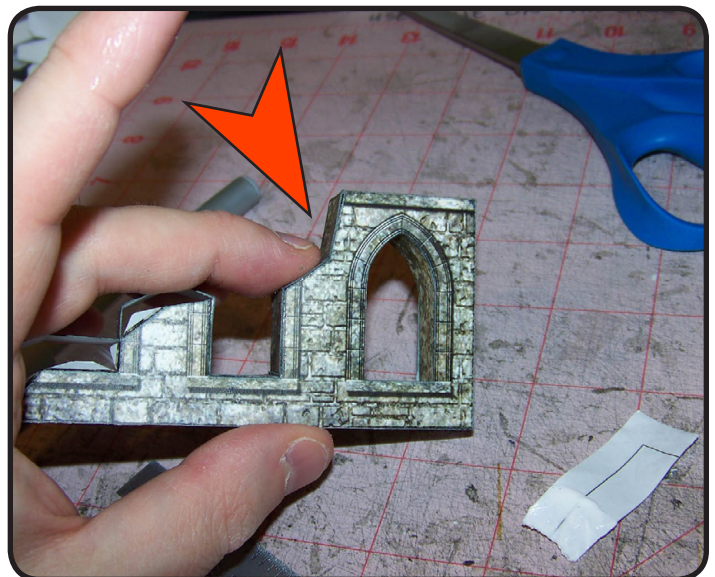

24: Next glue the upper section.

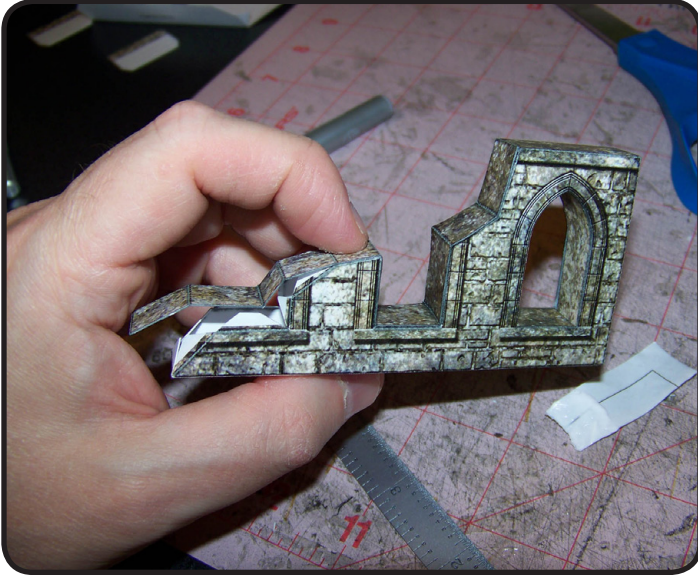

25: Glue the lower section a few tabs at a time and allow to dry.



26: The finished section.



E-Z LOCK Pillars & Broken Pillars

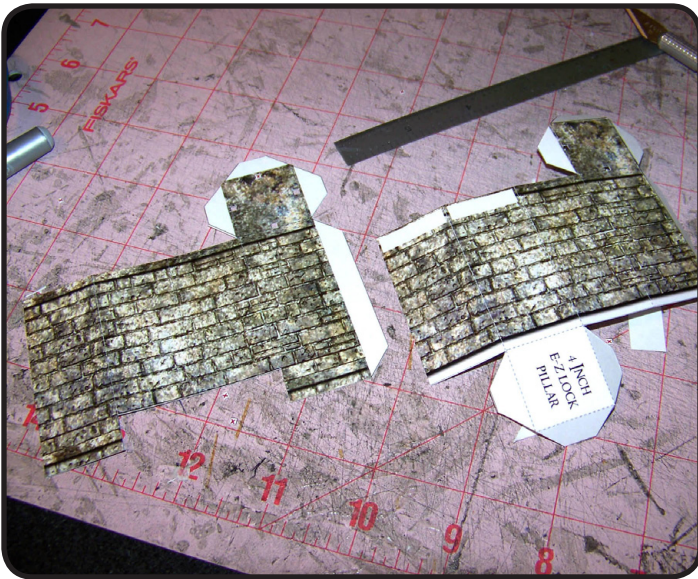

1: Cut, blah blah blabbidy blah blah...

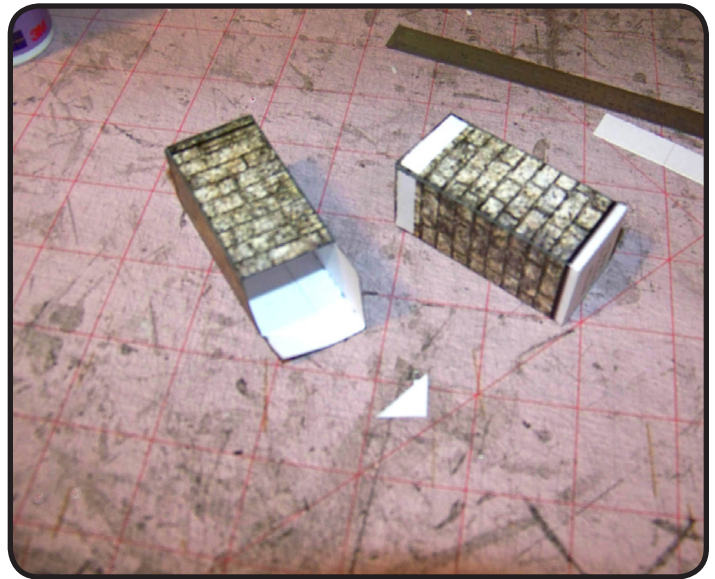

2: Fold and glue into box shapes as shown.

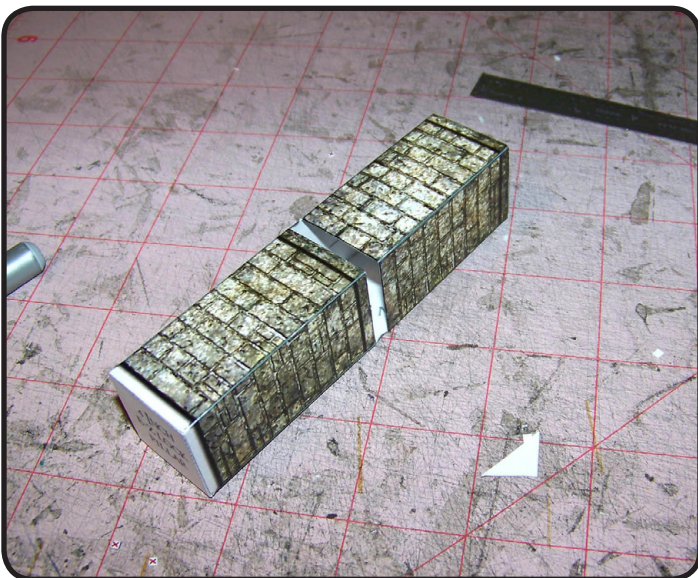

3: Glue together, being careful to properly align the pieces and not allow the top piece to drop below the level of the white glue areas. It may help to insert a small scrap of foamcore (with a piece of cardstock glued to one side for proper thickness) to ensure the proper gap is maintained.



4: Glue the broken pillar into a ring.



5: Glue the unbroken end next, holding against a flat surface for proper alignment of the edges.



6: Glue the remaining end, resting on a flat surface to aid in alignment.

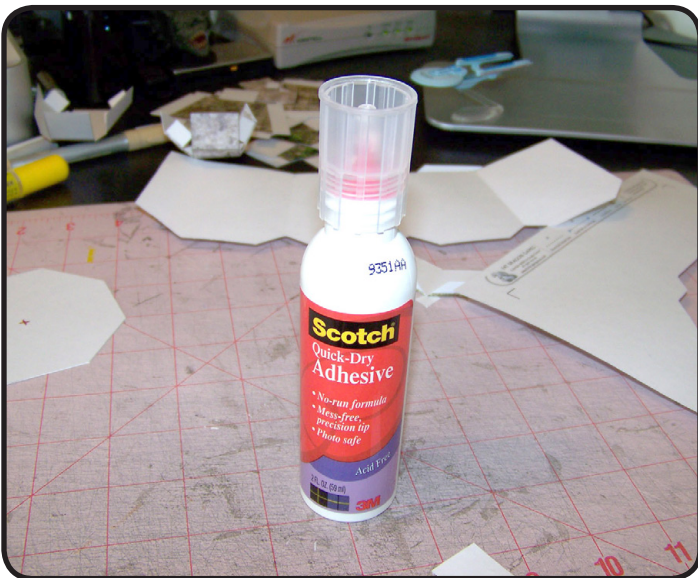

SCOTCH QUICK DRY ADHESIVE... THE BEST FREAKIN' PAPER MODELING GLUE EVER!!!!!!!
GET YOURSELF SOME!!!!



Upper levels

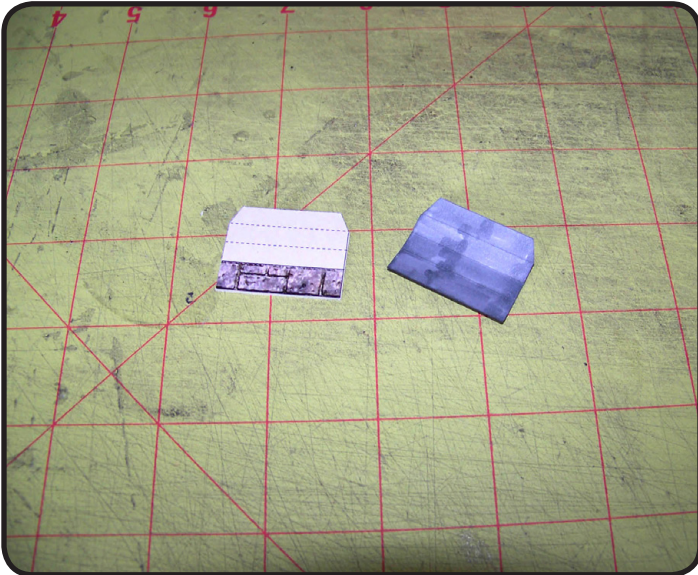

1: Color the rear side of the alignment guides as shown. Fold and glue these into triangle shapes and allow to dry.



2: Upper level pieces can be made as large as you require. Here is a simple 6x6 piece. Remember to use the edge strips that are included with this set to cover the edges of the foamcore.

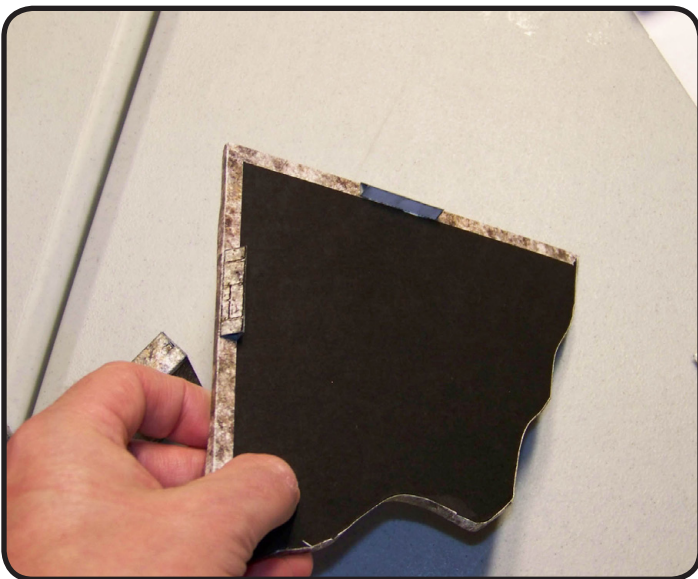

3: Glue in alignment guides, one per straight side of the upper flooring piece, as shown. Make sure they are far enough away from the corner as to not interfere with the 4" tall E-Z LOCK pillar.

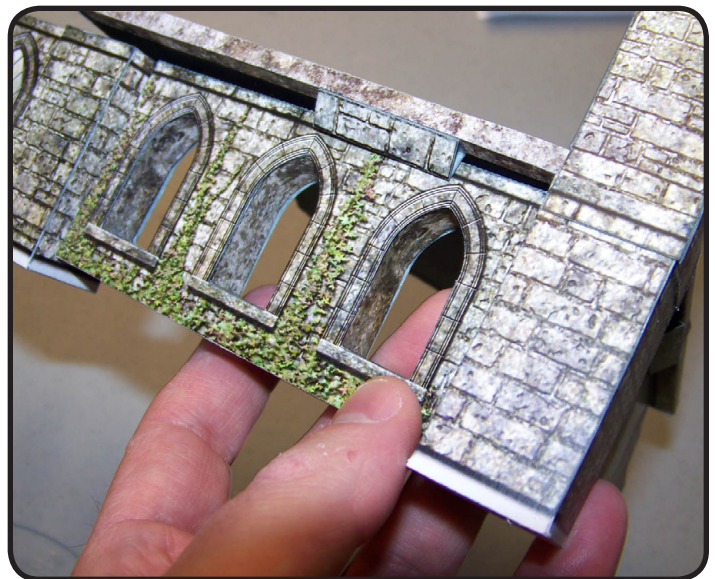

4: The upper floor corner simply inserts into the 4" E-Z LOCK pillar, and the alignment guides sit on the edges of the lower level walls to keep the upper level floor from shifting.



See the included Beginners Guide for complete instructions on the E-Z LOCK terrain system.

