



WWW.WORLDBUILDGAMES.COM

**CASTLEWORKS  
ULTIMATE™**



## Simple Crenelation

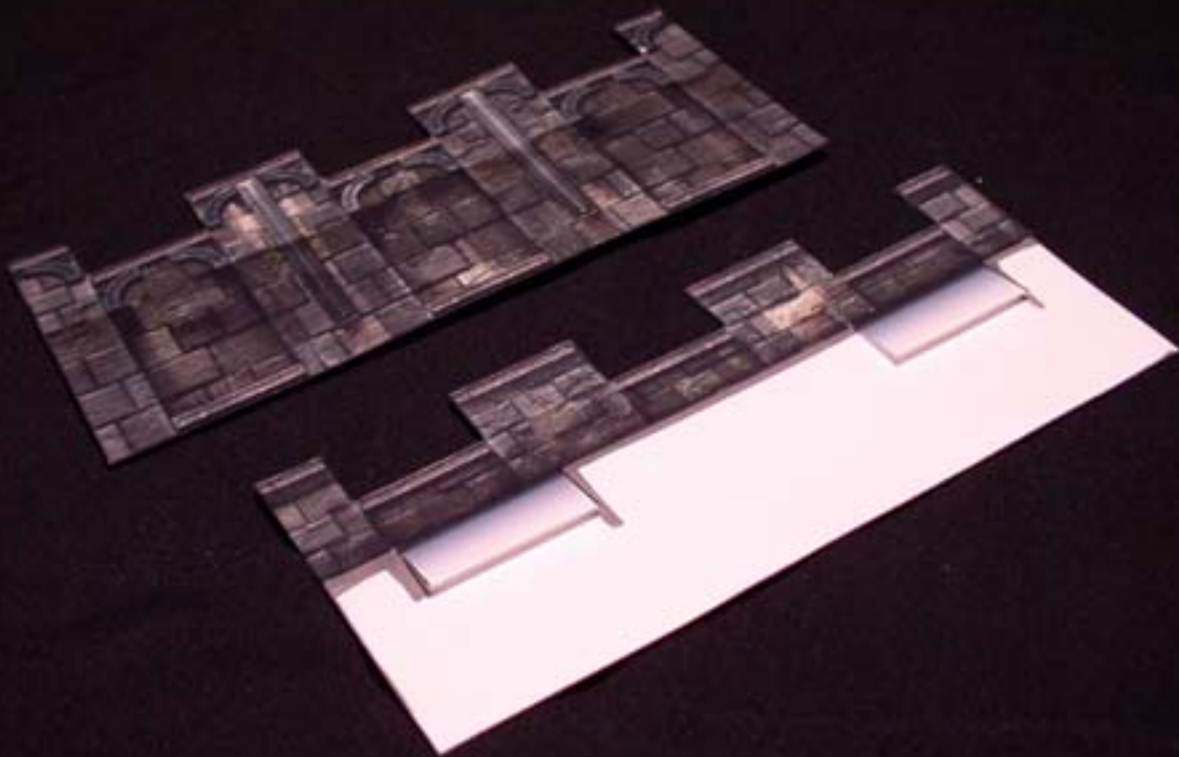

SIMPLE  
CRENELATION



Realizing that not everyone wants to take the extra time to build 3-D crenelations we have included a very quick build 2-D version for you. These only take minutes to build but still maintain a 3-D look and feel.

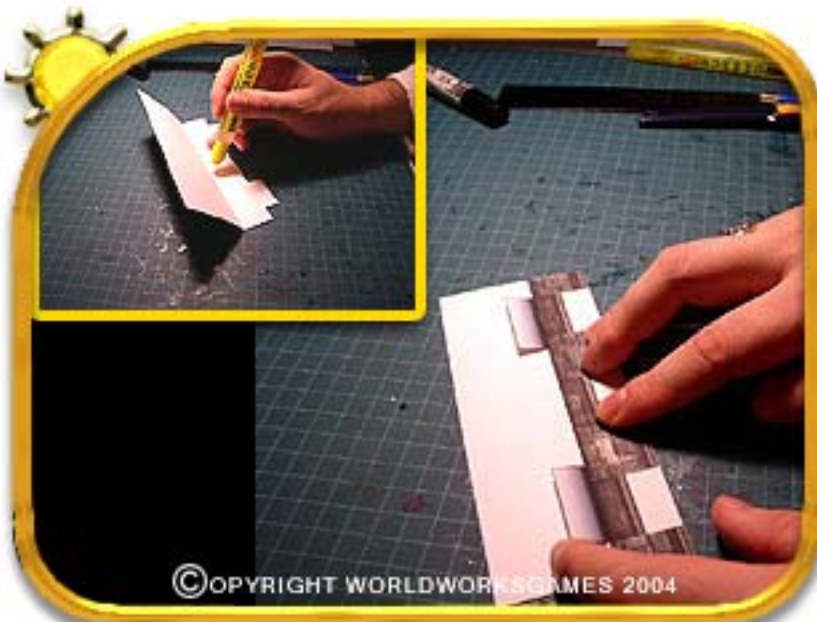

Fold over and glue the top portion on the crenelation.

Be careful not to glue down the wall inserts. Pull them back slightly to avoid gluing.

Once the model is dry cut away the white space between crenelations.



Take a few seconds and "Edge" your models with a dark felt. The end result is worth the extra minimal effort!



What is "Edging"? Please refer to the included Beginners Guide for step-by-step instruction.