



Star Command

e-Future Tiles: Star Command contains 19 ship component tiles for use with your favorite miniatures game or table top RPG. Simply print them, trim them out, and start playing. When printing, make sure that the **Print to Fit Page** option is clicked OFF so that the tiles will retain their one inch grid.



The content of this product is © 2004 by Edward Bourelle. The reproduction or retransmission of any part of this product, without written permission of the copyright holder is expressly forbidden, except for the purpose of reviews. Permission is granted to print this material for personal use only.

Product Code: SKG505e

ALTERNATE TILES



SC20

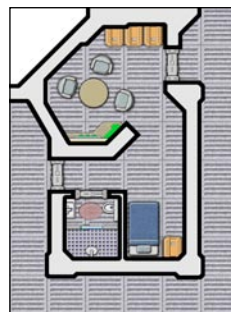

SC21

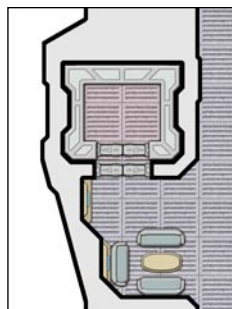

SC22



SC23

Alternate tiles are included at the end of this document that will expand the Star Command even further.

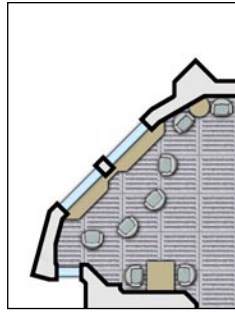

SC01

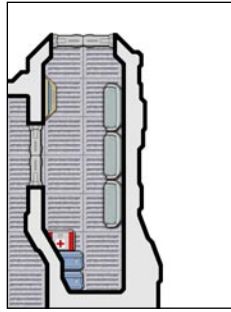

SC02

Print this page and cut it apart to design your terrain.
This will help you determine what tiles you need to
print out and help you save some ink.

All artwork is © 2004 - Edward Bourelle and
may be reproduced for personal use only.

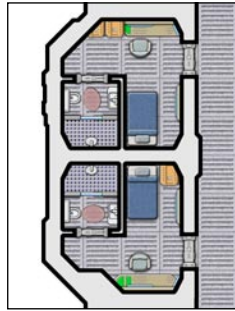

SC03



SC04

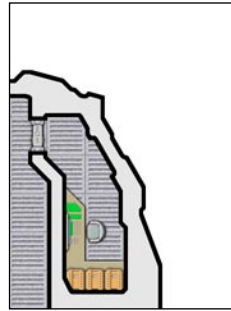

SC05

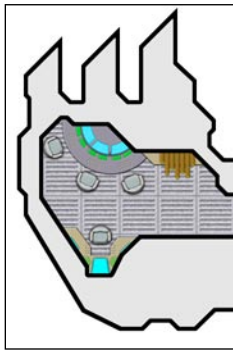

SC06

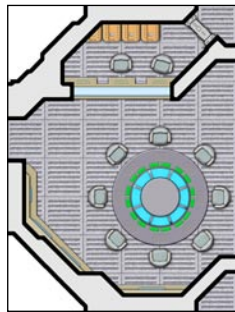

SC07

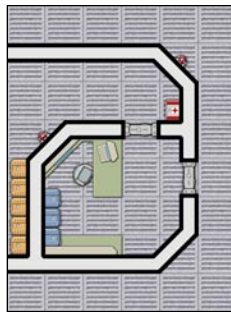

SC08



SC09



SC10



SC11



SC12

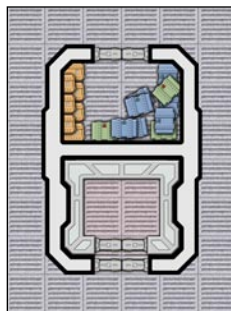

SC13



SC14

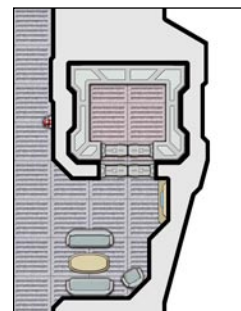

SC15

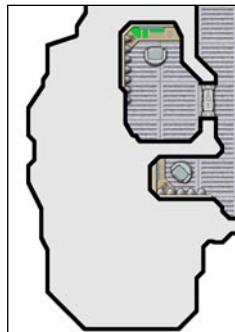

SC16

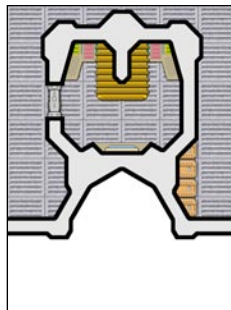

SC17

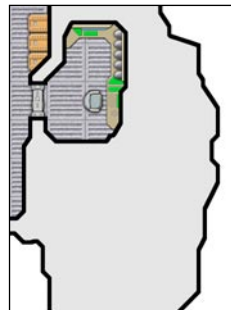

SC18

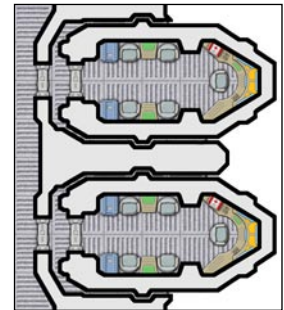

SC19

